



SAND FILTERS



Simple. Dependable. Effective.

Few things in life are as reliable as an AAT Sand Filter, providing peace of mind for you and nice clean water for the critters in your aquarium.

- ✓ Resistant to chemicals and ozone
- ✓ No corrosion-vulnerable metal components
- ✓ Can be back-washed automatically
- ✓ Easy to inspect and maintain
- ✓ Strong, durable, premium-grade Vinyl ester resin construction
- ✓ Quality fittings and valves as standard
- ✓ Water entering the chamber strikes a deflection-plate so the sand is not unduly disturbed
- ✓ One-piece replaceable septum nozzles on the flat bed plenum create a smooth, distributed flow.
- ✓ Versatile range - six different sizes
- ✓ Inspect the action inside through the large, transparent viewing port fitted as standard
- ✓ Premium aesthetics

Advanced Aquarium Technologies have pioneered unique techniques and technologies to design, build and operate inspiring and sustainable aquariums all over the world.

www.advanced-aquariums.com

DISCLAIMER: While drafted with due care and diligence, this flyer is provided "as is", the information may change without notification and we do not guarantee that the flyer is free from errors or defects.

TECHNICAL SPECIFICATIONS

Model	Filter size (Ø mm)	Filter cross sectional area (m²)	Flow rate biological (m³/hr)	Flow rate chemical (m³/hr)	Connection size (mm)	Nominal Dimensions of HRSF (mm)				Inlet (mm)	Outlet (mm)	Dry weight (kg)	Media Sand (kg)	Operation weight (kg)
						A (sand depth)	B (dia)	C (width)	D (height)					
						SF1200	1200	1.13	24					
SF1400	1400	1.54	33	50	114	600	1,440	1,506	1,668	1 x 110Ø	1 x 110Ø	352	1,240	2,909.26
SF1600	1600	2.01	43	65	114	650	1,640	1,706	1,840	1 x 160Ø	1 x 160Ø	428	1,720	4,136.06
SF1800	1800	2.54	55	82	168	700	1,840	1,931	2,177	1 x 160Ø	1 x 160Ø	566	2,440	5,860.91
SF2000	2000	3.14	68	102	168	750	2,040	2,134	2,310	1 x 160Ø	1 x 160Ø	646	3,340	7,928.97
SF2300	2300	4.15	90	135	225	750	2,340	2,475	2,440	1 x 225Ø	1 x 225Ø	777	4,260	11,081.78

Model	Filter size (Ø inch)	Filter cross sectional area (ft²)	Flow rate biological (gpm)	Flow rate chemical (gpm)	Connection size (inch)	Nominal Dimensions of HRSF (inch)				Inlet (inch)	Outlet (inch)	Dry weight (US lbs)	Media Sand (US lbs)	Operation weight (US lbs)
						A (sand depth)	B (dia)	C (width)	D (height)					
						SF1200	47	12.16	107					
SF1400	55	16.58	147	220	4"	24	57	59	66	1 x 4"	1 x 4"	776.03	2,733.73	6,413.82
SF1600	63	21.64	191	287	4"	26	65	67	72	1 x 6"	1 x 6"	943.58	3,791.95	9,118.44
SF1800	71	27.34	242	363	6"	28	72	76	86	1 x 6"	1 x 6"	1,247.82	5,379.28	12,921.10
SF2000	79	33.80	299	448	6"	30	80	84	91	1 x 6"	1 x 6"	1,424.19	7,363.44	17,480.38
SF2300	91	44.67	395	593	8"	30	92	97	96	1 x 225Ø	1 x 225Ø	1,712.99	9,391.69	24,431.13

DIMENSION REFERENCE

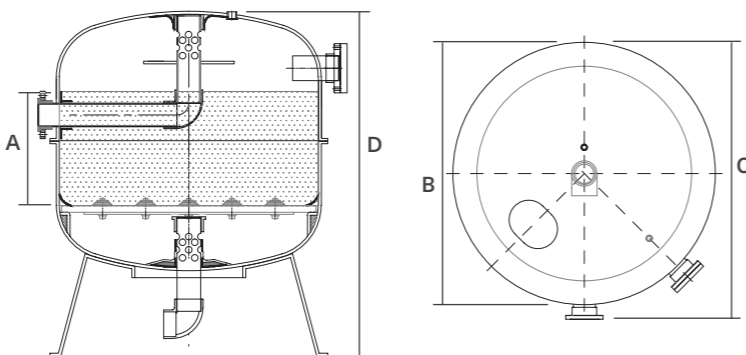

PRODUCT FEATURES

Full vinyl ester flow coat finish

Large view port included

Sand removal port included as a standard feature

Flat bed plenum utilising high density Diab closed cell foam

One piece removable septum nozzles with 0.3mm slotted pores for evenly distributed fluid flow

Vinyl ester resin used in construction for resistance to chemicals and ozone



The World's Premier
Aquarium Infrastructure
and Services Specialist

© AAT Advanced Aquarium Technologies Pty. Ltd. 2023

AUSTRALIA

office@advanced-aquariums.com
+61 7 5476 5300

USA

office@advanced-aquariums.com
+1 281 645-4004

CHINA

aat@advanced-aquariums.com
+86 20 3901 0651