

FOAM FRACTIONATORS



Keeping water clean with billions of tiny bubbles.

AAT Foam Fractionators effectively and efficiently remove microscopic organic compounds, protein particles, bacteria, water tints and other waterborne detritus from salt-water aquariums.

- ✓ Highly effective purification
- ✓ A versatile range with eight sizes available
- ✓ Resilient & durable
- ✓ No corrosion-vulnerable metals inside
- ✓ Resistant to chemicals and ozone
- ✓ Shipped worldwide & installed on-site in batches
- ✓ Easy to clean and maintain
- ✓ The rotating spray wash-down mechanism is the only moving part inside the chamber
- ✓ Georg Fischer fittings & valves as standard
- ✓ Tapered base reduces water exit velocity & allows fine bubbles to rise
- ✓ Venturi manifolds with tunable Mazzei injectors.
- ✓ Internal baffle plate for uniform fluid flow.

Advanced Aquarium Technologies have pioneered unique techniques and technologies to design, build and operate inspiring and sustainable aquariums all over the world.

www.advanced-aquariums.com

DISCLAIMER: While drafted with due care and diligence, this flyer is provided "as is", the information may change without notification and we do not guarantee that the flyer is free from errors or defects.

TECHNICAL SPECIFICATIONS

METRIC											
Model	Flow rates (m³/hr)		Process retention time @ max flow (sec)	Process column diameter (mm)	Unit Di-mension A (mm)	Unit Di-mension B (mm)	Inlet (mm)	Outlet (mm)	Venturi manifold connection (mm)	Dry weight (kg)	Operation weight (kg)
	Min.	Max.									
FF300	5	6	35	300	330	1,606	1 x 50Ø	1 x 90Ø	1 x 25Ø	22	102
FF400	8	10	35	400	460	1,650	1 x 50Ø	1 x 90Ø	1 x 25Ø	30	171
FF600	19	23	71	600	750	2,909	1 x 63Ø	1 x 110Ø	1 x 32Ø	98	739
FF1000	46	56	107	1,000	1,100	4,048	1 x 110Ø	1 x 160Ø	1 x 63Ø	245	2,444
FF1150s	64	78	87	1,150	1,370	3,712	1 x 110Ø	1 x 250Ø	1 x 63Ø	205	2,940
FF1150	64	78	107	1,150	1,370	4,182	1 x 110Ø	1 x 250Ø	1 x 63Ø	292	3,472
FF1500	118	144	145	1,500	1,870	5,209	1 x 160Ø	1 x 315Ø	1 x 90Ø	576	8,138
FF2000	204	249	145	2,000	2,300	5,209	1 x 225Ø	2 x 315Ø	1 x 90Ø	983	14,231

IMPERIAL											
Model	Flow rates (gpm)		Process retention time @ max. flow (sec)	Process column diameter (inch)	Unit Dimension A (inch)	Unit Dimension B (inch)	Inlet (inch)	Outlet (inch)	Venturi manifold connection (inch)	Dry weight (US lbs)	Operation weight (US lbs)
	Min.	Max.									
FF300	21	26	35	12	13	63	1 x 1½"	1 x 3"	1 x ¾"	49	224
FF400	36	44	35	16	18	65	1 x 1½"	1 x 3"	1 x ¾"	66	377
FF600	83	102	71	24	30	115	1 x 2"	1 x 4"	1 x 1"	216	1,628
FF1000	202	247	107	39	43	159	1 x 4"	1 x 6"	1 x 2"	540	5,387
FF1150S	281	344	87	45	54	146	1 x 4"	1 x 250Ø	1 x 2"	452	6,481
FF1150	281	344	107	45	54	165	1 x 4"	1 x 250Ø	1 x 2"	644	7,655
FF1500	518	633	145	59	74	205	1 x 6"	1 x 315Ø	1 x 3"	1,270	17,942
FF2000	896	1,095	145	79	91	205	1 x 225Ø	2 x 315Ø	1 x 3"	2,167	31,375



DIMENSION REFERENCE

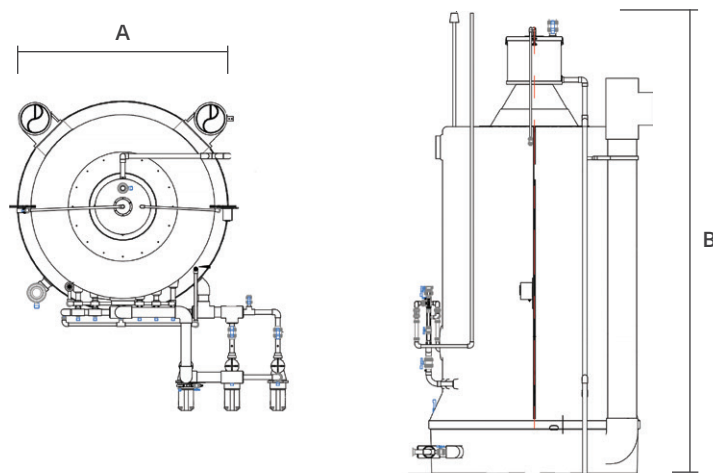

PRODUCT FEATURES

Wash down built-in, optional automation

Clear PVC dome and cone for simple control & diagnostic analysis

Internal baffle plate to control fluid flow and ensure uniform mixing

Vinyl ester resin used in construction for resistance to chemical and ozone attack

Clear tubes for inspecting venturi operation

High quality Georg Fischer fittings & valves

Tapered base to reduce water exit velocity and allow fine bubbles to rise

Venturi manifolds incorporating tunable Mazzai injectors

Option for air only or air and ozone mixtures.

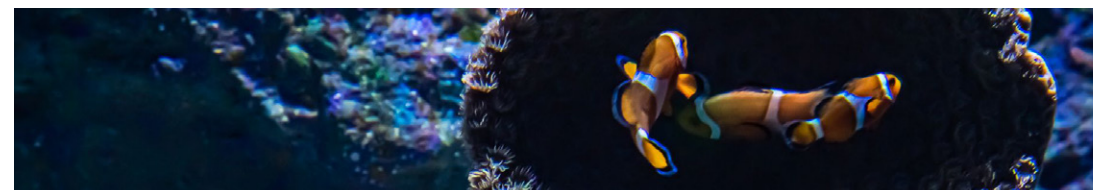

The World's Premier
Aquarium Infrastructure
and Services Specialist

© AAT Advanced Aquarium Technologies Pty. Ltd. 2023

AUSTRALIA

office@advanced-aquariums.com
+61 7 5476 5300

USA

office@advanced-aquariums.com
+1 281 645-4004

CHINA

aat@advanced-aquariums.com
+86 20 3901 0651



SAND FILTERS



Simple. Dependable. Effective.

Few things in life are as reliable as an AAT Sand Filter, providing peace of mind for you and nice clean water for the critters in your aquarium.

- ✓ Resistant to chemicals and ozone
- ✓ No corrosion-vulnerable metal components
- ✓ Can be back-washed automatically
- ✓ Easy to inspect and maintain
- ✓ Strong, durable, premium-grade Vinyl ester resin construction
- ✓ Quality fittings and valves as standard
- ✓ Water entering the chamber strikes a deflection-plate so the sand is not unduly disturbed
- ✓ One-piece replaceable septum nozzles on the flat bed plenum create a smooth, distributed flow.
- ✓ Versatile range - six different sizes
- ✓ Inspect the action inside through the large, transparent viewing port fitted as standard
- ✓ Premium aesthetics

Advanced Aquarium Technologies have pioneered unique techniques and technologies to design, build and operate inspiring and sustainable aquariums all over the world.

www.advanced-aquariums.com

DISCLAIMER: While drafted with due care and diligence, this flyer is provided "as is", the information may change without notification and we do not guarantee that the flyer is free from errors or defects.

TECHNICAL SPECIFICATIONS

METRIC														
Model	Filter size (Ø mm)	Filter cross sec- tional area m²	Flow rate biolog- ical (m³/hr)	Flow rate chemi- cal (m³/hr)	Connection size (mm)	Nominal Dimensions of HRSF (mm)				Inlet (mm)	Outlet (mm)	Dry weight (kg)	Media Sand (kg)	Operation weight (kg)
						A (sand depth)	B (dia)	C (width)	D (height)					
SF1200	1200	1.13	24	37	114	530	1,288	1,345	1,597	1 x 110Ø	1 x 110Ø	286	820	1,923.39
SF1400	1400	1.54	33	50	114	600	1,440	1,506	1,668	1 x 110Ø	1 x 110Ø	352	1,240	2,909.26
SF1600	1600	2.01	43	65	114	650	1,640	1,706	1,840	1 x 160Ø	1 x 160Ø	428	1,720	4,136.06
SF1800	1800	2.54	55	82	168	700	1,840	1,931	2,177	1 x 160Ø	1 x 160Ø	566	2,440	5,860.91
SF2000	2000	3.14	68	102	168	750	2,040	2,134	2,310	1 x 160Ø	1 x 160Ø	646	3,340	7,928.97
SF2300	2300	4.15	90	135	225	750	2,340	2,475	2,440	1 x 225Ø	1 x 225Ø	777	4,260	11,081.78

IMPERIAL														
Model	Filter size (Ø inch)	Filter cross sec- tional area ft²	Flow rate biolog- ical (gpm)	Flow rate chemi- cal (gpm)	Connection size (inch)	Nominal Dimensions of HRSF (inch)				Inlet (inch)	Outlet (inch)	Dry weight (US lbs)	Media Sand (US lbs)	Operation weight (US lbs)
						A (sand depth)	B (dia)	C (width)	D (height)					
SF1200	47	12.16	107	161	4"	21	51	53	63	1 x 4"	1 x 4"	630.52	1,807.79	4,240.35
SF1400	55	16.58	147	220	4"	24	57	59	66	1 x 4"	1 x 4"	776.03	2,733.73	6,413.82
SF1600	63	21.64	191	287	4"	26	65	67	72	1 x 6"	1 x 6"	943.58	3,791.95	9,118.44
SF1800	71	27.34	242	363	6"	28	72	76	86	1 x 6"	1 x 6"	1,247.82	5,379.28	12,921.10
SF2000	79	33.80	299	448	6"	30	80	84	91	1 x 6"	1 x 6"	1,424.19	7,363.44	17,480.38
SF2300	91	44.67	395	593	8"	30	92	97	96	1 x 225Ø	1 x 225Ø	1,712.99	9,391.69	24,431.13



DIMENSION REFERENCE

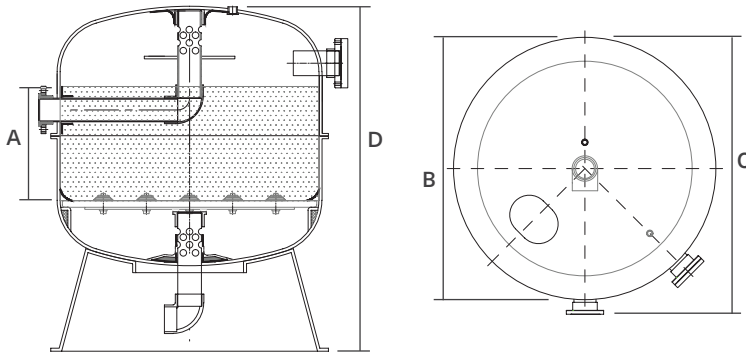

PRODUCT FEATURES



The World's Premier
Aquarium Infrastructure
and Services Specialist

© AAT Advanced Aquarium Technologies Pty. Ltd. 2023

AUSTRALIA

office@advanced-aquariums.com
+61 7 5476 5300

USA

office@advanced-aquariums.com
+1 281 645-4004

CHINA

aat@advanced-aquariums.com
+86 20 3901 0651

BAG FILTERS



Engineered for versatility and ease of installation.

Ideal for a wide range of filtering and water treatment applications, these filters are particularly beneficial for life support systems in space-constrained plant-rooms.

- ✓ Ideal for small systems - a simple and robust alternative to sand-filtration.
- ✓ Often specified for systems under 20,000 litres (depending on factors and circumstances).
- ✓ Perfect for space-constrained plant rooms.
- ✓ Easy to install with flexible mounting options - base only, or wall and base, or wall only.
- ✓ Removable handle means less area required in plant room for mounting.
- ✓ Pipe size reducers enable connections from 4" to 2".
- ✓ Easy bag removal due to built-in bleed vent in the lid and hinged basket handle.
- ✓ 125µm standard filter bag (heavy-duty seamless felt)
- ✓ Connects easily to new/existing infrastructure.
- ✓ Four in-built mounting positions so the unit can be 'rotated' (on vertical axis).

Advanced Aquarium Technologies have pioneered unique techniques and technologies to design, build and operate inspiring and sustainable aquariums all over the world.

www.advanced-aquariums.com

DISCLAIMER: While drafted with due care and diligence, this flyer is provided "as is", the information may change without notification and we do not guarantee that the flyer is free from errors or defects.

TECHNICAL SPECIFICATIONS

METRIC					
GENERAL SPECIFICATIONS		FILTER BAG			
Inlet/Outlet Port Size	2", 3", 4" BSPT - Female	Micron Rating (µm)	Flow Rate* (m3/hr)	PE/PP Felt	NMO
Temperature (°C)	4 - 70	3 - 10	3.0 - 4.8	✓	
Operating Pressure (bar)	0 - 7	25 - 100	6.8 - 11.8	✓	✓
Max Flow Rate (m³/hr)	40	125 (standard)	12.9	✓	✓
Filter Bag Dim (mm)	Ø180 x 810	150 - 300	13.8 - 18.1	✓	✓
Filter Basket Vol (L)	10	500 - 1000	22.2 - 30.0		✓
MATERIALS OF CONSTRUCTION		2000 - 3750	36.0 - 40.0		✓
Housing	GF PP	*Flow rate will vary depending on filterbag micron rating installed, and raw water quality. 125µm is the standard filter bag included (1 pc only)			
O'Ring	EPDM				

IMPERIAL					
GENERAL SPECIFICATIONS		FILTER BAG			
Inlet/Outlet Port Size	2", 3", 4" BSPT - Female	Micron Rating (µm)	Flow Rate* (gpm)	PE/PP Felt	NMO
Temperature (°F)	39.2 - 158	3 - 10	13.2 - 21.1	✓	
Operating Pressure (PSI)	0 - 100	25 - 100	30.0 - 52.0	✓	✓
Max Flow Rate (gpm)	176.1	125 (standard)	56.8	✓	✓
Filter Bag Dim (inches)	Ø7 x 32	150 - 300	60.8 - 79.7	✓	✓
Filter Basket Vol (gal)	2.64	500 - 1000	97.7 - 132		✓
MATERIALS OF CONSTRUCTION		2000 - 3750	158.5 - 176.1		✓
Housing	GF PP	*Flow rate will vary depending on filterbag micron rating installed, and raw water quality. 125µm is the standard filter bag included (1 pc only)			
O'Ring	EPDM				



DIMENSION REFERENCE

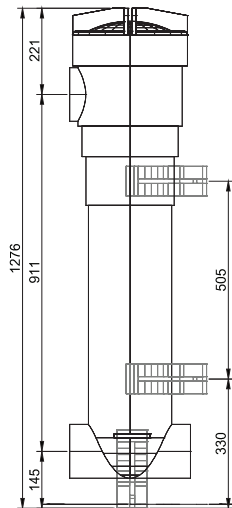
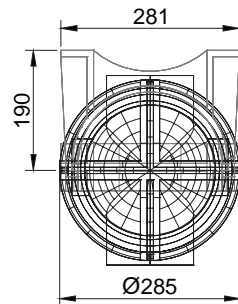

PRODUCT FEATURES

Built-in bleed vent in lid

connection sizes from 2" to 4"

Heavy-duty, seamless felt bags

Multi-function handle fitted to basket, for easy bag removal

One-piece injection moulding construction

Flow rate up to 12m³/hr @ 125 µm

Flexible mounting options - base only, wall & base, or wall only

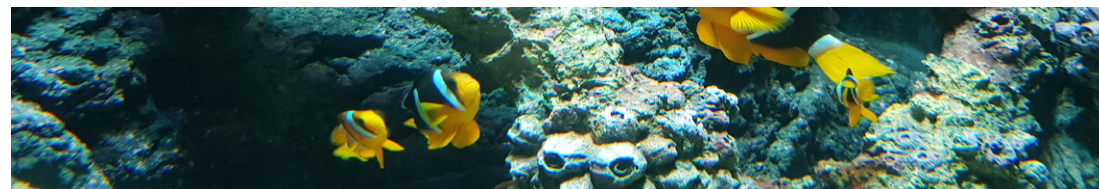
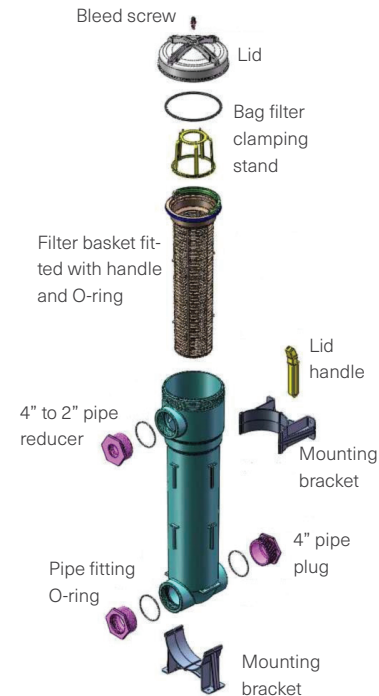
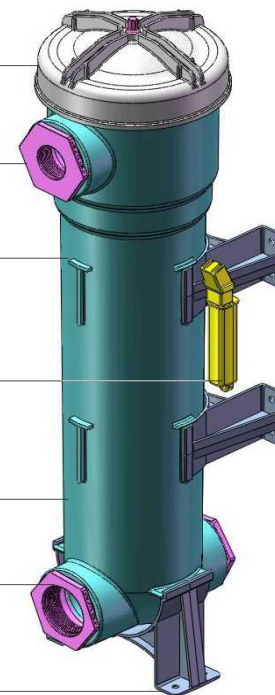

The World's Premier
Aquarium Infrastructure
and Services Specialist

© AAT Advanced Aquarium Technologies Pty. Ltd. 2023

AUSTRALIA
office@advanced-aquariums.com
+61 7 5476 5300

USA
office@advanced-aquariums.com
+1 281 645-4004

CHINA
aat@advanced-aquariums.com
+86 20 3901 0651

HEAT EXCHANGERS



Why waste thermal energy when you can repurpose it?

'Redeploying' thermal energy that might otherwise go to waste help lowers the environmental footprint of the aquarium, saves money and helps maintain exhibit water at appropriate temperatures.

- ✓ Premium materials construction - stainless steel external casing with titanium plates.
- ✓ Corrosion-resistant.
- ✓ Each plate is individually sealed with gaskets for both air and fluids.
- ✓ New plates can be added quickly or existing ones replaced.
- ✓ The flow distribution is alternated allowing counter-current flow for maximum efficiency.
- ✓ Simple operation and maintenance.
- ✓ Robust
- ✓ Plates can withstand high differential pressures.
- ✓ Low price-point and low operating cost.

Advanced Aquarium Technologies have pioneered unique techniques and technologies to design, build and operate inspiring and sustainable aquariums all over the world.

www.advanced-aquariums.com

DISCLAIMER: While drafted with due care and diligence, this flyer is provided "as is", the information may change without notification and we do not guarantee that the flyer is free from errors or defects.

TECHNICAL SPECIFICATIONS

METRIC															
MODEL:	HE-5 kW	HE-10 kW	HE-15 kW	HE-20 kW	HE-30 kW	HE-50 kW	HE-75 kW	HE-100 kW	HE-120 kW	HE-150 kW	HE-200 kW	HE-300 kW	HE-350 kW	HE-500 kW	HE-800 kW
Nominal Cooling/Heating Capacity (kW)	5	10	15	20	30	50	75	100	120	150	200	300	350	500	800
Heat exchange area, m²	0.5	0.8	1.0	1.2	1.6	2.6	4.0	5.5	6.5	8.0	11.0	16.0	19.0	28.0	45.0
Height, H, (mm)	590						900						1175		1784
Width, W, (mm)	244						320						460		620
Vertical connection dist., VC, (mm)	420						640						846		1293
Horizontal connection dist., HC, (mm)	104						140						223		296
Connection size, flange (mm)	DN40						DN50						DN100		DN150
Max flow rate, (kg/s)	1.11	1.78	2.22	2.67	3.56	5.78	6.11	8.40	9.93	12.22	16.81	22.22	26.39	38.89	45.83
Max flow rate, (m3/h)	4	6	8	10	13	21	22	30	36	44	61	80	95	140	165
Max temperature, (°C)	150														
Max pressure, (barg)	10														
Flow principle	Parallel														
Materials	Plate - Titanium; Gasket - EPDM; Frame - Stainless steel clad														

IMPERIAL																
MODEL:	HE-5 kW	HE-10 kW	HE-15 kW	HE-20 kW	HE-30 kW	HE-50 kW	HE-75 kW	HE-100 kW	HE-120 kW	HE-150 kW	HE-200 kW	HE-300 kW	HE-350 kW	HE-500 kW	HE-800 kW	
Nominal Cooling/Heating Capacity (kW)	5	10	15	20	30	50	75	100	120	150	200	300	350	500	800	
Heat exchange area, ft²)	5.4	8.6	10.8	12.9	17.2	28.0	43.1	59.2	70.0	86.1	118.4	172.2	204.5	301.4	484.4	
Height, H, (inch)	23						35						46		70	
Width, W, (inch)	10						13						18		24	
Vertical connection dist., VC, (inch)	17						25						33		51	
Horizontal connection dist., HC, (inch)	4						6						9		12	
Connection size, flange (inch)	1½"						2"						4"		6"	
Max flow rate, (lbs/s)	2.4	3.9	4.9	5.9	7.8	12.7	13.4	18.5	21.8	26.9	37.0	48.9	58.1	85.6	100.8	
Max flow rate, (gpm)	17.6	28.2	35.2	42.3	56.4	91.6	96.9	133.2	157.4	193.7	266.4	352.2	418.3	616.4	726.5	
Max temperature, (°F)	302															
Max pressure, (barg)	10															
Flow principle	Parallel															
Materials	Plate - Titanium; Gasket - EPDM; Frame - Stainless steel clad															



PRODUCT FEATURES

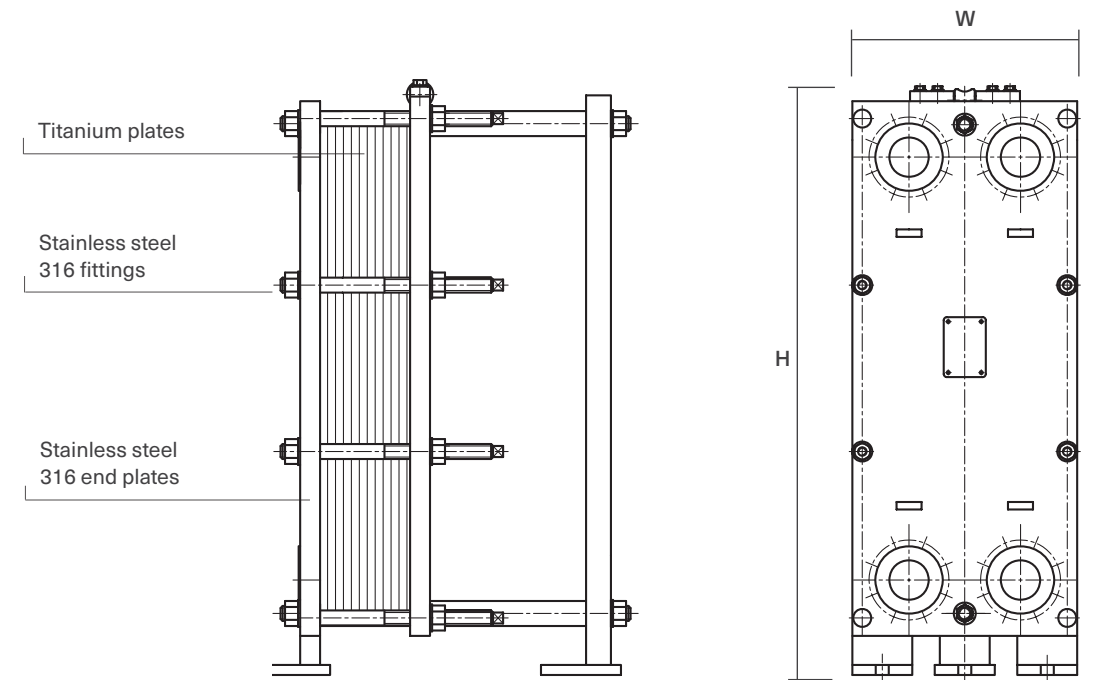

**The World's Premier
Aquarium Infrastructure
and Services Specialist**

© AAT Advanced Aquarium Technologies Pty. Ltd. 2023

AUSTRALIA
office@advanced-aquariums.com
+61 7 5476 5300

USA
office@advanced-aquariums.com
+1 281 645-4004

CHINA
aat@advanced-aquariums.com
+86 20 3901 0651

UV STERILIZERS

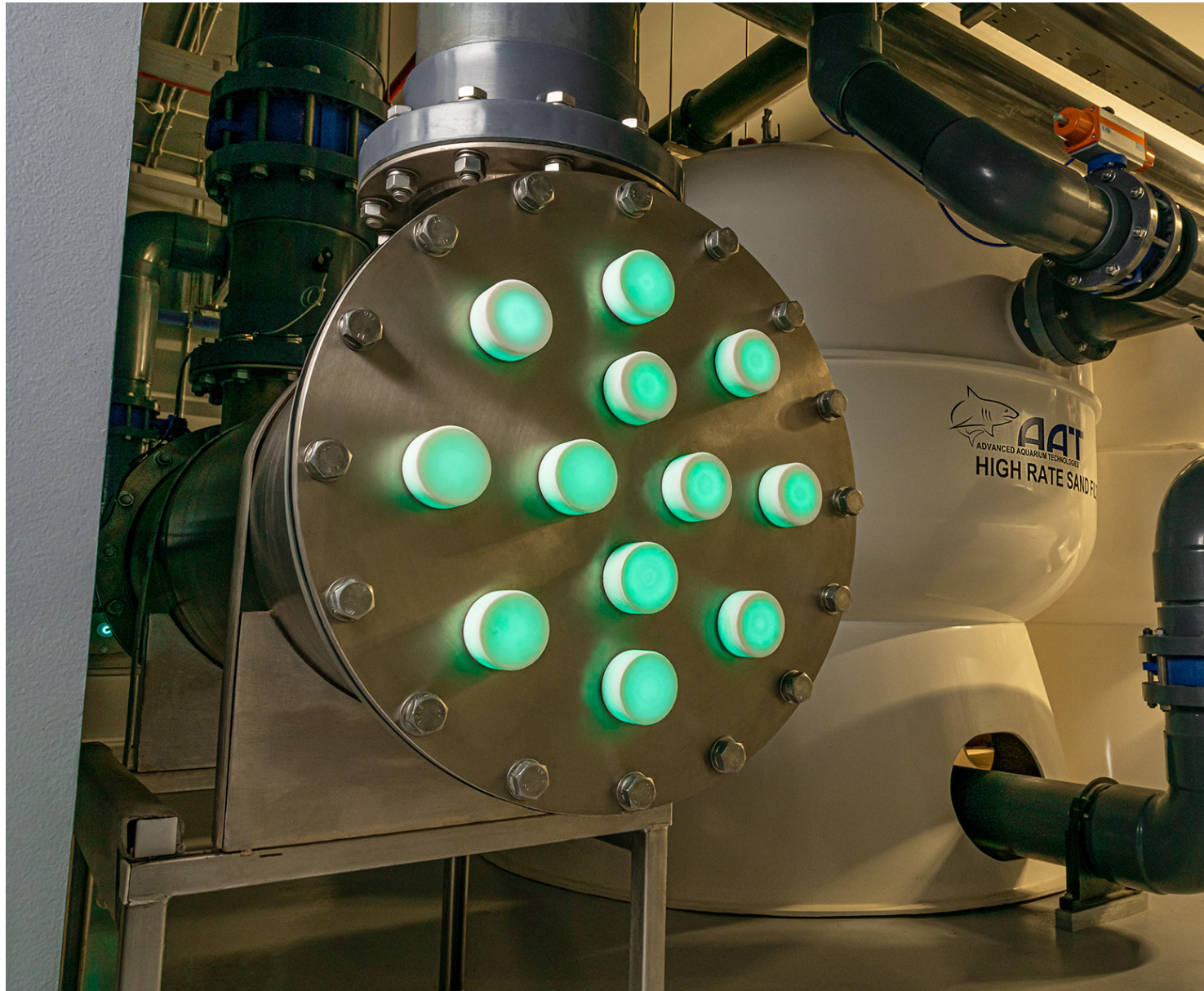

Safe & economical protection against pathogens.

Ultraviolet germicidal irradiation uses short-wave length ultraviolet light to inactivate microorganisms by destroying nucleic acids and disrupting DNA, so they're unable to perform cellular functions.

- ✓ Destroys single-celled organisms, bacteria, viruses, algae, fungi and protozoa, with no residual effects.
- ✓ Contains several UV lamps arranged in an array utilising UV output to its maximum potential.
- ✓ Single or multi-lamp units for a range of flow and dose rates.
- ✓ No toxic by-products produced.
- ✓ Light output mostly at 254 nm wavelength, the peak of the Germicidal Spectrum.
- ✓ Protective quartz sleeves thermally protect the UV lamps for maximum UV output and safety.
- ✓ Alarms and interlocking for flow, temperature, and faults.
- ✓ Corrosion resistant titanium and stainless steel options maximise durability and operating performance
- ✓ UV lamp life is estimated to be one year or 10,000 hours depending on operational conditions.
- ✓ Easily installed as a stand-alone package or integrated into a new or existing system.
- ✓ Require minimal maintenance and servicing.

Advanced Aquarium Technologies have pioneered unique techniques and technologies to design, build and operate inspiring and sustainable aquariums all over the world.

www.advanced-aquariums.com

DISCLAIMER: While drafted with due care and diligence, this flyer is provided "as is", the information may change without notification and we do not guarantee that the flyer is free from errors or defects.

TECHNICAL SPECIFICATIONS

METRIC										
Model	Lamps	Flow capacity (m³/hr)	UV lamp power (kW)	A (mm) Length	B (mm) Lamp Access	C (mm) Height	D (mm) Width	Electrical Panel Size		
								E (mm) Length	F (mm) Height	G (mm) Width
UV 300	1	22.50	0.30	1,650	2,159	267	331	400	500	160
UV 600	2	45.00	0.60	1,650	2,159	379	451	400	500	160
UV 900	3	67.50	0.90	1,650	2,159	379	451	530	730	255
UV 1200	4	90.00	1.20	1,650	2,159	379	451	530	730	255
UV 1500	5	112.50	1.50	1,650	2,159	434	506	530	730	255
UV 1800	6	135.00	1.80	1,650	2,159	485	555	530	730	255
UV 2100	7	157.50	2.10	1,650	2,159	485	555	530	730	255
UV 2400	8	180.00	2.40	1,650	2,159	541	615	530	730	255
UV 3000	10	250.00	3.00	1,650	2,159	544	615	630	830	285
UV 3600	12	270.00	3.60	1,650	2,159	726	780	630	830	285

IMPERIAL										
Model	Lamps	Flow capacity (gsm)	UV lamp power (kW)	A (inch) Length	B (inch) Lamp Access	C (inch) Height	D (inch) Width	Electrical Panel Size		
								E (inch) Length	F (inch) Height	G (inch) Width
UV 300	1	99.06	0.30	64.96	85.00	10.51	13.03	15.75	19.69	6.30
UV 600	2	198.13	0.60	64.96	85.00	14.92	17.76	15.75	19.69	6.30
UV 900	3	297.19	0.90	64.96	85.00	14.92	17.76	20.87	28.74	10.04
UV 1200	4	396.26	1.20	64.96	85.00	14.92	17.76	20.87	28.74	10.04
UV 1500	5	495.34	1.50	64.96	85.00	17.09	19.92	20.87	28.74	10.04
UV 1800	6	594.39	1.80	64.96	85.00	19.09	21.85	20.87	28.74	10.04
UV 2100	7	691.25	2.10	64.96	85.00	19.09	21.85	20.87	28.74	10.04
UV 2400	8	792.52	2.40	64.96	85.00	21.30	24.21	20.87	28.74	10.04
UV 3000	10	1,100.75	3.00	64.96	85.00	21.42	24.21	24.80	32.68	11.22
UV 3600	12	1,188.77	3.60	64.96	85.00	28.58	30.71	24.80	32.68	11.22

DIMENSION REFERENCE

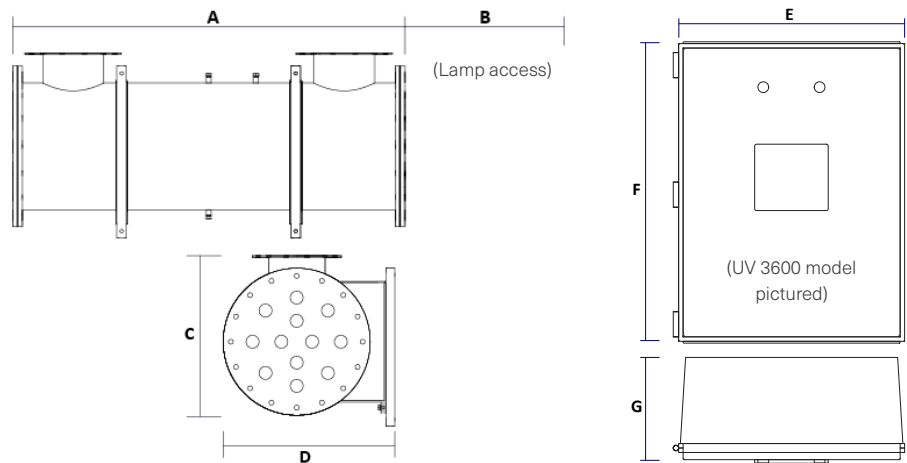

PRODUCT FEATURES

Long water exposure times due to elongated unit design greatly improves the electromagnetic radiation efficiency

A quartz sleeve is used to isolate the UV lamps from the water allowing optimal lamp temperature for highly efficient operation

Housing made from titanium or a stainless steel option, which has a high strength to weight ratio, high corrosion resistance to salt water plus high temperature tolerance.

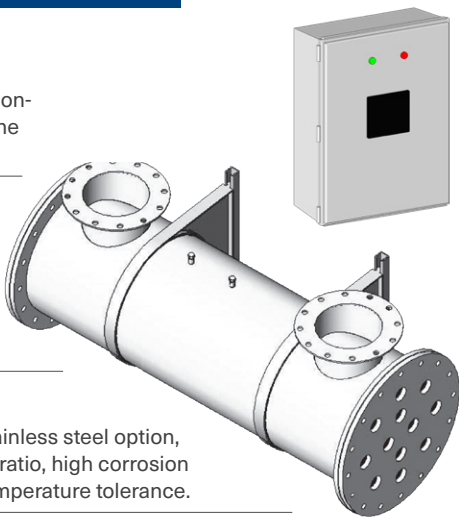

- Easy operator access for control options
- Flow, thermal and remote interlocks as standard.
- Remote start/stop control options as standard.
- Remote run/fault output options as standard.
- Remote monitoring of reactor operating temperature.
- If a fault is detected, the system interlocks to prevent overheating.

VERSATILE

- ✓ Suitable for fresh and saltwater.
- ✓ Recommended for aquarium inflow water, recirculation systems and effluent water.
- ✓ Stainless steel option for freshwater.

AUTOMATION

- ✓ System interlocks prevent overheating of the unit by automatically shutting off the UV lamps if a fault is detected.
- ✓ Internal service alert for lamps when low.
- ✓ SMS and email alerts with the optional alarm monitoring system.

EFFICIENT

- ✓ A high rate of 40% of electrical power is converted into usable UV-C watts for the system.
- ✓ The UV lamps run on low input power currents of 200 to 1,500 mA.



The World's Premier
Aquarium Infrastructure
and Services Specialist

© AAT Advanced Aquarium Technologies Pty. Ltd. 2023

AUSTRALIA

office@advanced-aquariums.com
+61 7 5476 5300

USA

office@advanced-aquariums.com
+1 281 645-4004

CHINA

aat@advanced-aquariums.com
+86 20 3901 0651

OZONE GENERATORS

**A safe supply of ozone,
produced at the point
of use.**

**For flocculation, when used in conjunction with an
AAT Foam Fractionator, and oxidation, when used in
conjunction with an AAT Contact Chamber**



- ✓ AAT Ozone Generators enable aquariums to generate their own stable supply of oxidizer.
- ✓ Beyond combating toxins and odours, AAT Ozone Generators also improve water clarity by counteracting the undesirable effects of organic material in aquarium exhibits that cause clouding and discolouring.
- ✓ Plant-room friendly - fit into systems with ease, requiring minimal space.
- ✓ Available in stainless steel or powder-coated cabinets, wall or stand-mounted options available.
- ✓ Automatically controlled with its integrated HMI/PLC interface displaying ozone output control, fault alarms, pre-programmed interlocks and 4-20 mA control.
- ✓ Connection to ozone in air alarms.
- ✓ Integral Flow meter displayed for easy reference.

Advanced Aquarium Technologies have pioneered unique techniques and technologies to design, build and operate inspiring and sustainable aquariums all over the world.

www.advanced-aquariums.com

DISCLAIMER: While drafted with due care and diligence, this flyer is provided "as is", the information may change without notification and we do not guarantee that the flyer is free from errors or defects.

TECHNICAL SPECIFICATIONS

METRIC							
OZONE GENERATOR							
Model	Output (g/hr)	Oxygen Flow (L/min)	Reaction Pressure (Mpa)	Power (W)	Width (mm)	Height (mm)	Depth (mm)
B3-05	5	3	0.1	450	650	1035	370
B3-10	10	3	0.1	550	650	1035	370
B3-30	30	5	0.1	950	650	1035	370
B3-60	60	10	0.1	1800	750	1200	650
B3120	120	20	0.1	3400	1000	1720	800
* To maximise ozone production use Ozone Generator in conjunction with a high-quality Air Dryer to remove moisture from the gas stream							

IMPERIAL							
OZONE GENERATOR							
Model	Output (g/hr)	Oxygen Flow (US gpm)	Reaction Pressure (PSI)	Power (W)	Width (inch)	Height (inch)	Depth (inch)
B3-05	5	0.79	14.5	450	25.6	40.8	14.6
B3-10	10	0.79	14.5	550	25.6	40.8	14.6
B3-30	30	1.32	14.5	950	25.6	40.8	14.6
B3-60	60	2.64	14.5	1800	29.5	47.2	25.6
B3120	120	5.28	14.5	3400	39.4	67.7	31.5
* To maximise ozone production use Ozone Generator in conjunction with a high-quality Air Dryer to remove moisture from the gas stream							



Ozone Generator with Air Dryer under



PRODUCT FEATURES

Ceramic reaction chamber with air cooling

Integral flow meter

Air intake flow regulator

Standard power module of high frequency and pressure

Air cooler

(Powder-coated steel model pictured)

HMI touch screen control

- Pressure guage of reaction chamber of -1 to 1.5kgf/cm²
- Ozone operating indicator.
- Adjust oxygen flow rate
- PLC for process auto-mation.
- Automatic power-off protection in case of overheat, over current or cabinet door opening.



AUSTRALIA

office@advanced-aquariums.com

+61 7 5476 5300

USA

office@advanced-aquariums.com

+1 281 645-4004

CHINA

aat@advanced-aquariums.com

+86 20 3901 0651

The World's Premier Aquarium Infrastructure and Services Specialist

© AAT Advanced Aquarium Technologies Pty. Ltd. 2023

SKID-MOUNTED LSS



Pre-fabricated, plug and play LSS plants, made to order.

Made in a quality-controlled factory environment and shipped ready to go, anywhere in the world. Capable of supporting tanks up to 30,000 litres (7,900 gallons)

- ✓ Electrical system adaptable from simple socket plug up to full HMI touch screen control with alarm outputs.
- ✓ Tidy and compact – optimise the use of space.
- ✓ All the components remain easily accessed for simple operation and maintenance.
- ✓ Flexibility to adjust the set points and change animals in the exhibit.
- ✓ Premium quality components - built to last in corrosive environments.
- ✓ Ready-to-go with all of the critical elements in a life support system (built to bespoke specifications)
- ✓ Installed in multiple leading aquariums around the world.

Advanced Aquarium Technologies have pioneered unique techniques and technologies to design, build and operate inspiring and sustainable aquariums all over the world.

www.advanced-aquariums.com

DISCLAIMER: While drafted with due care and diligence, this flyer is provided "as is", the information may change without notification and we do not guarantee that the flyer is free from errors or defects.

TECHNICAL SPECIFICATIONS

METRIC							
Model	Design Flow Rate through Exhibit (m³/hr)	Dimension A Width (m)	Dimension B Depth (m)	Dimension C Height (m)	Approx. Dry Weight (kg)	Operating Water Volume (m³)	Total Operating Weight (kg)
Mini Skid 1	2	1.020	0.600	1.095	200.00	0.08	280
Mini Skid 2	6	1.500	0.800	1.335	230.00	0.20	430
AAT Skid 1	9.5	1.600	1.140	2.100	370.00	0.44	810
AAT Skid 2	13	2.250	1.500	2.500	600.00	0.70	1,300
AAT Skid 3	17	2.600	1.500	2.500	660.00	1.12	1,780
AAT Skid 4	20	4.000	1.510	2.500	1,050.00	2.50	3,550
AAT Skid 5	40	7.100	1.800	2.500	1800 ~ 2000	5.05	6850 - 7050

IMPERIAL							
Model	Design Flow Rate through Exhibit (gpm)	Dimension A Width (inch)	Dimension B Depth (inch)	Dimension C Height (inch)	Approx. Dry Weight (lbs)	Operating Water Volume (ft³)	Total Operating Weight (lbs)
Mini Skid 1	9	40.16	23.62	43.11	440.92	2.83	617
Mini Skid 2	26	59.06	31.50	52.56	507.06	7.06	948
AAT Skid 1	42	62.99	44.88	82.68	815.71	15.54	1,786
AAT Skid 2	57	88.58	59.06	98.43	1,322.77	24.72	2,866
AAT Skid 3	75	102.36	59.06	98.43	1,455.05	39.55	3,924
AAT Skid 4	88	157.48	59.45	98.43	2,314.85	88.29	7,826
AAT Skid 5	176	279.53	70.87	98.43	3970 - 4410	178.34	15100 - 15543

PRODUCT FEATURES

STANDARD INCLUSIONS

- 2-4 x Pumps
- Foam Fractionator.
- Bag Filters.
- FRP Break Tank.
- Bio Tower.
- Pre-Filter Screen/s.
- Heat Pump.
- UV Sterilizer
- Flow switch pump protection.
- Manual Isolation and Control valves.
- All FRP skid-mounted.

OPTIONAL EXTRAS

- HMI/PLC upgrade.
- Remote monitoring and controls/SCADA.
- Supports optional sensors.
 - » pH
 - » ORP
 - » Temp
 - » Flow Meter
 - » Pressure Transducer.
 - » Salinity
 - » More upon request
- HEX
- Splash Guards

DIMENSION REFERENCE

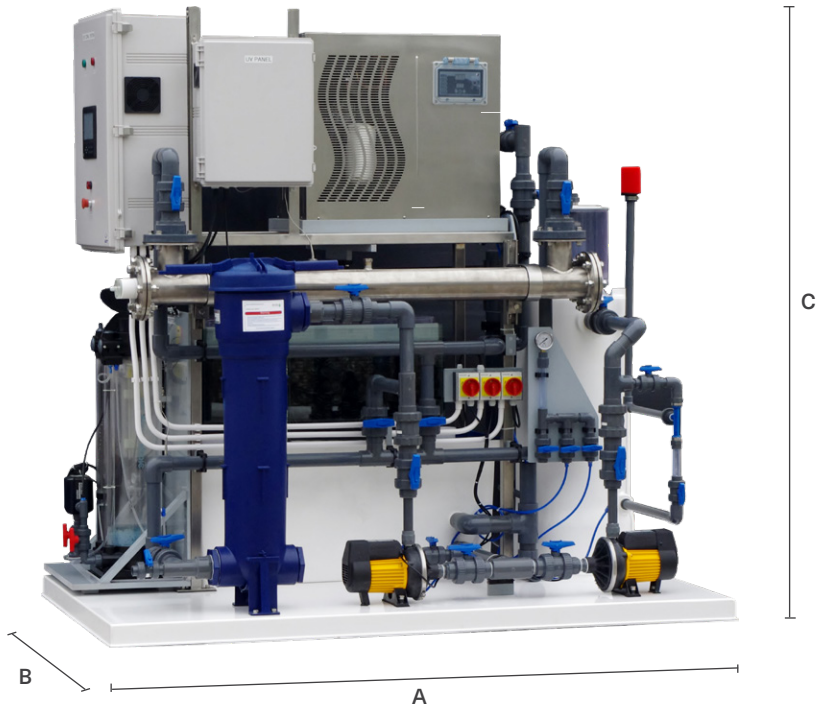

The World's Premier
Aquarium Infrastructure
and Services Specialist

© AAT Advanced Aquarium Technologies Pty. Ltd. 2023

AUSTRALIA

office@advanced-aquariums.com
+61 7 5476 5300

USA

office@advanced-aquariums.com
+1 281 645-4004

CHINA

aat@advanced-aquariums.com
+86 20 3901 0651

HEAT PUMPS



Maintain perfect water temperature automatically.

Stable water temperature is critical to animal health therefore temperature control is critical. AAT Heat Pumps provide an effective and energy-efficient heating and cooling process.

- ✓ Sensor-enabled, these heat pumps automatically adjust the compressor operation to keep exhibit water temperatures at optimum.
- ✓ Evaporators constructed from industrial-grade titanium that prevents corrosion by seawater.
- ✓ Compressors supplied by global brands resulting in greater stability and power saving features.
- ✓ Highly efficient pipe-fin condensers produced by OAK.
- ✓ EBM fans and motors, from Germany, offer low noise and vibration.
- ✓ Digital temperature controller.
- ✓ Available in a range of sizes and refrigerants.
- ✓ Proven robust and reliable all over the world.
- ✓ Uses less energy than 'heaters and coolers'.

Advanced Aquarium Technologies have pioneered unique techniques and technologies to design, build and operate inspiring and sustainable aquariums all over the world.

www.advanced-aquariums.com

DISCLAIMER: While drafted with due care and diligence, this flyer is provided "as is", the information may change without notification and we do not guarantee that the flyer is free from errors or defects.

TECHNICAL SPECIFICATIONS

METRIC & IMPERIAL																	
MODEL	Nominal Cooling/Heating Capacity (kW)	Nominal Cooling/Heating Capacity (BTU)	Power Rating (kW)	Power Supply	Nominal Power of Compressor (kW)	Nominal Power of Fan (w)	Refrigerant	Ambient TEMP	Operational Water TEMP	DIMS							
										Connection Size	A - Depth (mm / inch)	B - Width (mm / inch)	C - Height (mm / inch)	NET weight (kg / lbs)			
ENV-HP-27HC	2.7/(2.7)	9212/(9212)	1.02	220V ~/50Hz	0.92	1 x 100	R410C	≤40 °C / ≤104 °F	8 ~ 30 °C / 46.4 ~ 86 °F	1 ½" BSP				34kg / 75lbs			
ENV-HP-36HC	3.6/(3.6)	12283/(12283)	1.35		1.25									768 mm 30 inch	286 mm 11 inch	575 mm 23 inch	63.5kg / 140lbs
ENV-HP-52HC	5.2/(5.2)	17742/(17742)	1.85		1.70												66kg / 146lbs
ENV-HP-72HC	7.2/(7.2)	24566/(24566)	2.56		2.41									898 mm 35 inch	375 mm 15 inch	823 mm 32 inch	72 kg / 159 lbs
ENV-HP-85HC	8.5/(8.5)	29002/(29002)	2.88	380V ~/50Hz	2.73	1 x 153	R407C	≤40 °C / ≤104 °F	8 ~ 30 °C / 46.4 ~ 86 °F	3" BSP				84 kg / 185 lbs			
ENV-HP-145C	14.5/NA	49474/NA	4.66		4.35									890 mm 35 inch	368 mm 14 inch	1325 mm 52 inch	100 kg / 220 lbs
ENV-HP-145HC	14.5/(14.5)	49474/(49474)	4.66		4.35												113 kg / 249 lbs
ENV-HP-900C	90/NA	307092/NA	9.85		13.62x2						3 x 670						2600mm 102.4 "

DIMENSION REFERENCE

Model:
ENV-HP-27HC

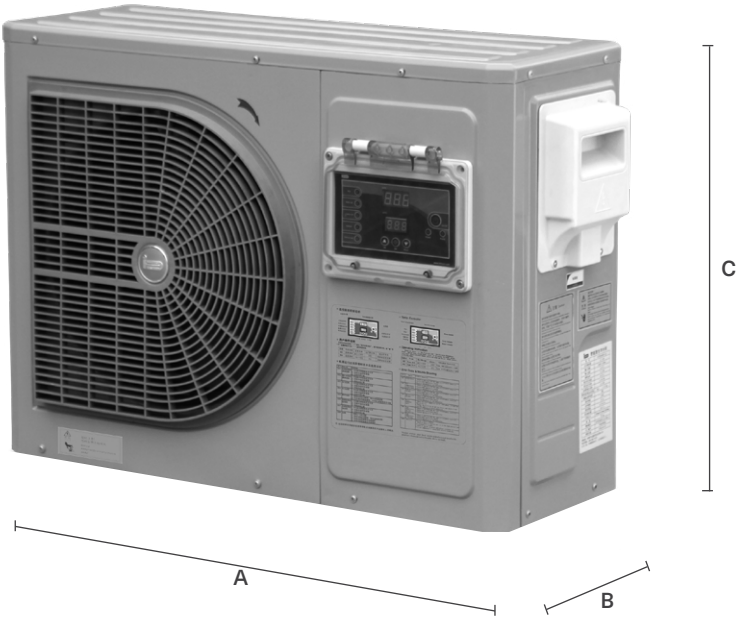

PRODUCT FEATURES

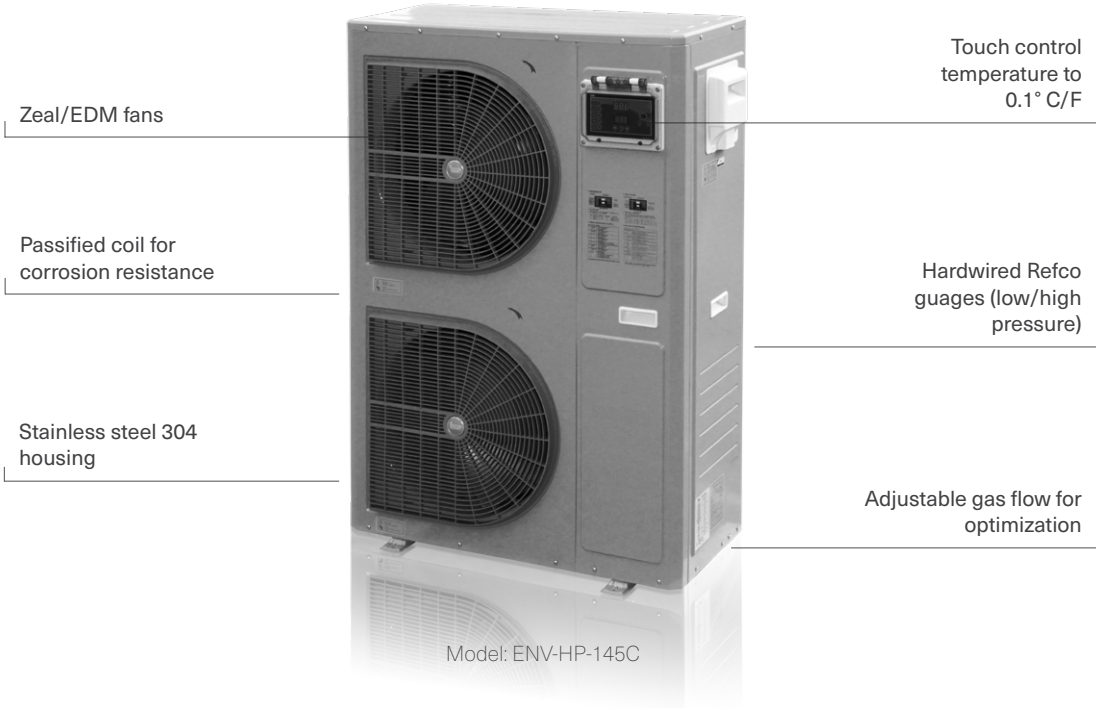

The World's Premier
Aquarium Infrastructure
and Services Specialist

© AAT Advanced Aquarium Technologies Pty. Ltd. 2023

AUSTRALIA
office@advanced-aquariums.com
+61 7 5476 5300

USA
office@advanced-aquariums.com
+1 281 645-4004

CHINA
aat@advanced-aquariums.com
+86 20 3901 0651



Bespoke, hand-crafted, install-ready exhibit tanks.

Available for delivery anywhere in the world, AAT's prefabricated exhibit tanks provide highest quality at a lower price than on-site construction

- ✓ Versatile, beautiful and cost-efficient, AAT pre-fabricated tanks can be produced in batches for large aquarium projects or we design one-off bespoke designs for aquarium reonvations and feature installations in hotels, resorts, airports, office, hospitals and other venues.
- ✓ A cost-efficient solution for new aquariums or when refurbishing and expanding older facilities.
- ✓ Strong and robust - steel frames and high-quality FRP for exceptional strength and durability.
- ✓ Constructed by highly skilled workers - over 20 years of experience building FRP tanks.
- ✓ Assembled in a highly-controlled environment.
- ✓ A complete solution typically supplied with authentic AAT rockwork, creative theme elements and acrylic panels, fully hydro-tested.

Advanced Aquarium Technologies have pioneered unique techniques and technologies to design, build and operate inspiring and sustainable aquariums all over the world.

www.advanced-aquariums.com

DISCLAIMER: While drafted with due care and diligence, this flyer is provided "as is", the information may change without notification and we do not guarantee that the flyer is free from errors or defects.

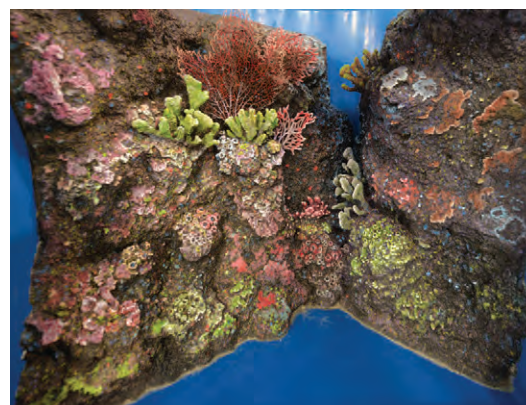
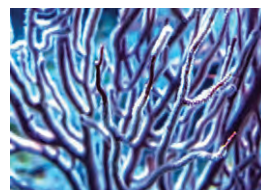

**The World's Premier
Aquarium Infrastructure
and Services Specialist**

© AAT Advanced Aquarium Technologies Pty. Ltd. 2023

AUSTRALIA
office@advanced-aquariums.com
+61 7 5476 5300

USA
office@advanced-aquariums.com
+1 281 645-4004

CHINA
aat@advanced-aquariums.com
+86 20 3901 0651

ACCESS PLATFORM & STAIRS



Safe and durable, work-task friendly, tank access.

Curators, aquarists and other staff need workplace-safe access to tanks and LSS's. AAT FRP platforms are strong, durable, corrosion resistant and fully customisable.

- ✓ Constructed primarily from super strong FRP material that is inert and resistant to corrosion.
- ✓ 316 stainless steel fasteners.
- ✓ Can be fabricated to bespoke and unusual designs or configurations.
- ✓ An excellent solution for workplace health and safety projects, especially for working safely at heights and creating safety barriers.
- ✓ Fully design service available, or built to your order.
- ✓ Adjust the designs to make the barriers and configurations work-task friendly for staff.
- ✓ Can be shipped anywhere in the world.
- ✓ Ask about our installation service too.

Advanced Aquarium Technologies have pioneered unique techniques and technologies to design, build and operate inspiring and sustainable aquariums all over the world.

www.advanced-aquariums.com

DISCLAIMER: While drafted with due care and diligence, this flyer is provided "as is", the information may change without notification and we do not guarantee that the flyer is free from errors or defects.

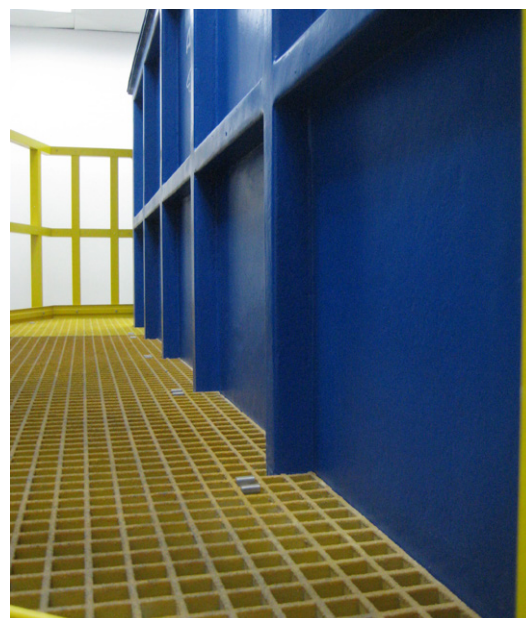
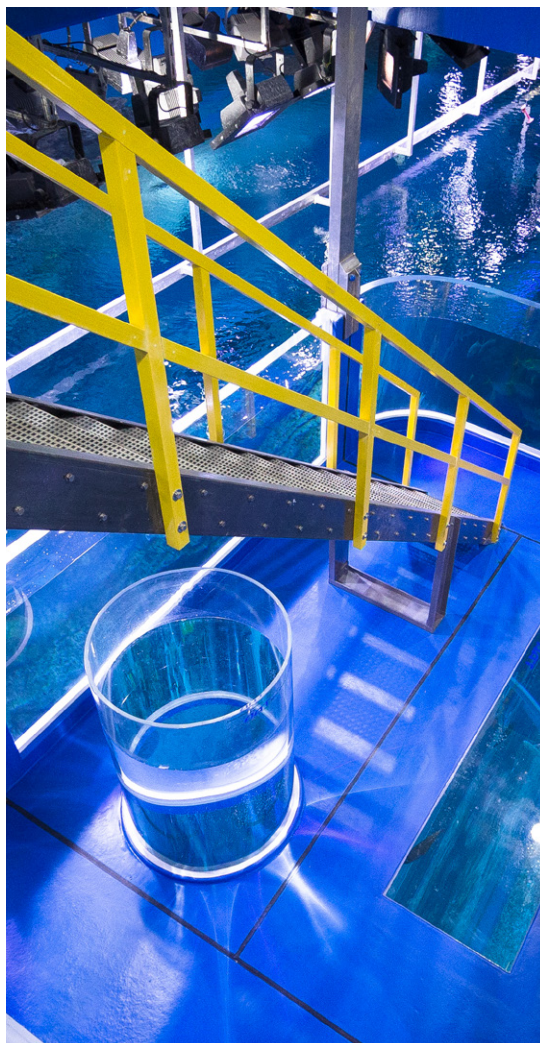

**The World's Premier
Aquarium Infrastructure
and Services Specialist**

© AAT Advanced Aquarium Technologies Pty. Ltd. 2023

AUSTRALIA
office@advanced-aquariums.com
+61 7 5476 5300

USA
office@advanced-aquariums.com
+1 281 645-4004

CHINA
aat@advanced-aquariums.com
+86 20 3901 0651